



CITY OF CAPE TOWN  
ISIXEKO SASEKAPA  
STAD KAAPSTAD

## **BOSASA IDA**

ISWWS: INFORMAL SETTLEMENTS & BACKYARDERS  
PRESENTATION PREPARED BY WALEED ADAMS

Making progress possible. **Together.**

# PROJECT BACKGROUND & PURPOSE FOR DEVELOPMENT

---

## Settlement Background

- Household count 4412
- Density 147 du-Ha
- Located off Lansdowne Road Khayelitsha
- Settlement age +20 years old

## Background on Emergency

- Fire occurred 31/12/12
- 792 dwellings destroyed
- Displacing 3200 people



# FIRE AREA

---

Fire aftermath



# THE RESCUE PLAN

---

The fire that occurred necessitated a quick response and an expedited plan of action referred to as the BM Section Rescue Plan which is being over seen by the Urbanisation/Informal Settlements Department within the Human Settlements Directorate

- OR Tambo TRA (Temporary Relocation Area)
- BM Section TRA
- Busasa IDA (Incremental Development Area)
- BM Section Spatial Reconfiguration Plan

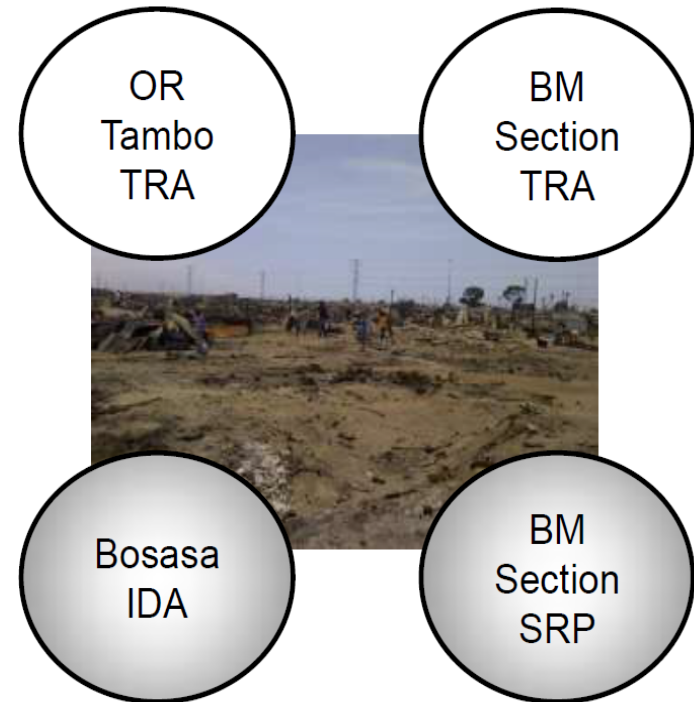

# OR TAMBO TRA

---

- 6m x 3m temporary dwelling structure.
- Pre assembled wall panels made up of corrugated metal sheeting and thermal insulation on light weight steel framework
- Wall panels anchored to 100mm concrete surface beds (in-situ, precast pavers can be used as alternative)
- 141 TRA Structures completed in 14 days
- Structure can be assembled by 3-4 unskilled labour with manufacturer's supervision.
- Water and sanitation provided at a 1:4 ratio



# BM SECTION REBLOCKING

- 3m x 3m temporary dwelling structure.
- 5 x 76mm x 76mm x 2.7m timber poles ,9 x 76mm x 50mm x 3.0m timber poles, 5 x 3.3m x 610mm and 20 x 2.4m x 610mm (cover) galvanised corrugated steel roof sheets, 1 x wooden batten door, 1 x 600mm x 600mm glazed wooden window, and consumables.
- 420 Structures completed in 14 days (30p/d)
- Structure can be assembled by 3-4 unskilled labour with no supervision required
- Water and sanitation provided at a 1:4 ratio

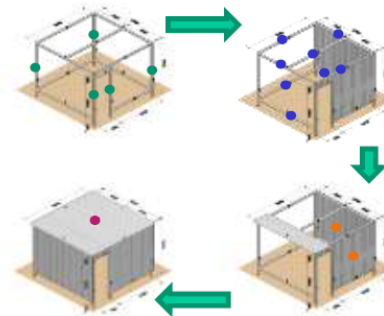

THIS CITY WORKS FOR YOU



# BOSASA INCREMENTAL DEVELOPMENT AREA

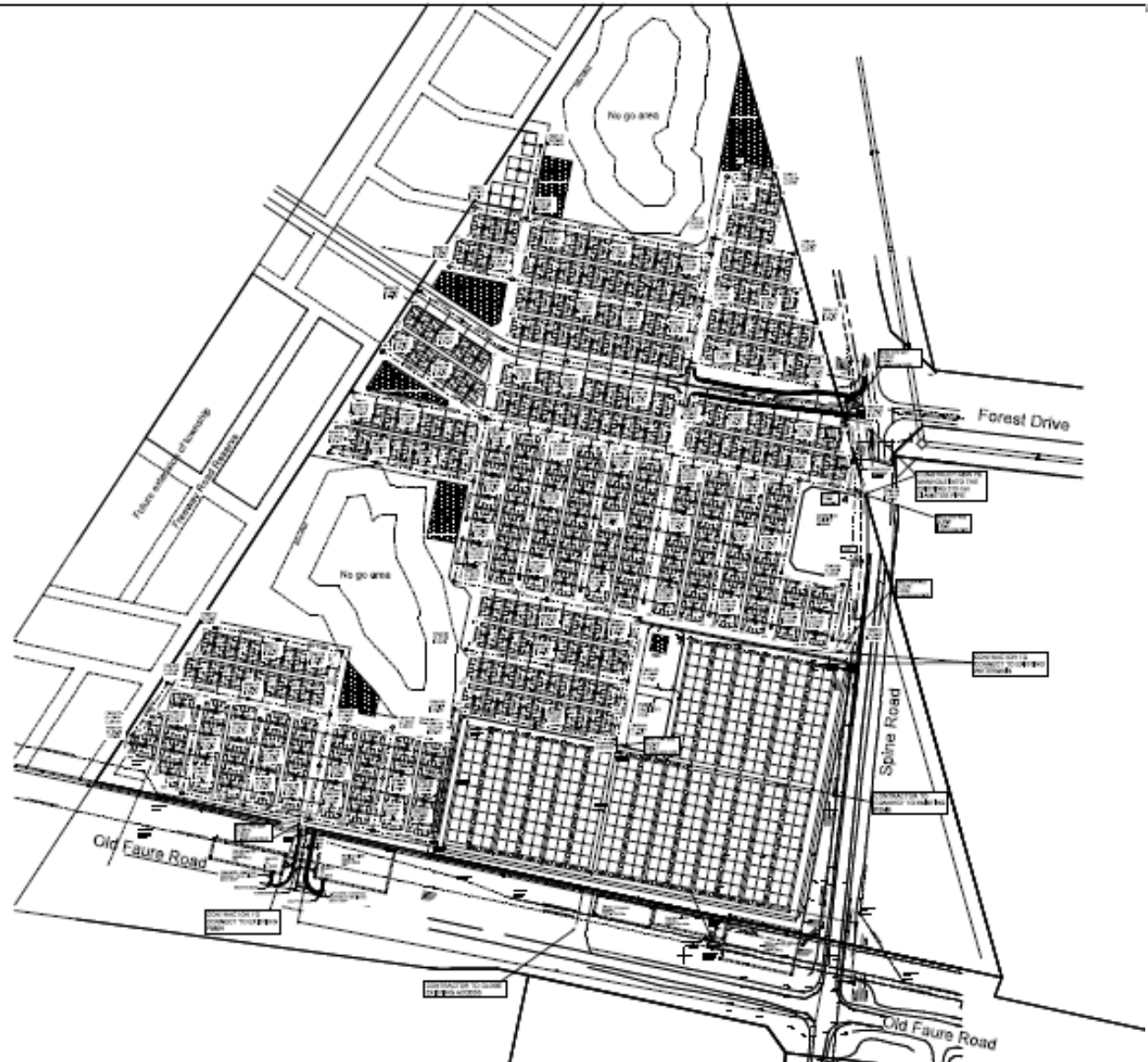

# BOSASA INCREMENTAL DEVELOPMENT AREA

---

- 26sqm dwelling structure.(technology allows for additions)
- Pre-assembled wall panels made up of corrugated metal sheeting and thermal insulation on light weight steel framework
- Wall panels anchored to 75mm concrete surface beds (in-situ, precast pavers can be used as alternative)
- 20 dwelling units completed per day
- +1000 dwelling units to be completed in 6 Months
- Structure can be assembled by 3-4 unskilled labour with manufacturer's supervision.
- Internal water and sanitation provided at a 1:1 ratio





# CIVIL ENGINEERING SERVICES INSTALLED

## ➤ **ROADS**

- ✓ Internal gravel roads have been provided to the site, whilst the entrance to the development has been constructed to black top standard.



## ➤ **GRAVEL PLATFORMS & OVERLAND STORMWATER DRAINAGE**

- ✓ the newly constructed platform allows for overland storm water run off.

## ➤ **WATER RETICULATION**

- ✓ Formal under ground water infrastructure has been installed/constructed to service the development.



## ➤ **SEWERAGE RETICULATION AND TOILETS**

- ✓ Formal under ground reticulation installed, Sanitation will be provided at 1:1 ratio (internal toilets)

## ➤ **EMERGENCY TOP STRUCTURES**

- ✓ Beneficiaries will be provided with a 26 m<sup>2</sup> emergency housing structure, which consists of a prefabricated light gauge steel structure with corrugated cladding. Each structure will be fitted with an internal toilet and wash basin.



# ENGINEERING SERVICES INSTALLED

---

## ➤ **PROVISION OF ELECTRICITY TO DWELLINGS**

- ✓ The site is within the Eskom Supply Area. The City has engaged with Eskom to provide electricity to the site. All structures will be provided with an electrical connection via a 'Ready Board' and a pre-paid meter.

## ✓ **FENCING**

- ✓ The entire development will be fenced with a concrete palisade fence.

# TYPICAL UNIT

---



# TYPICAL UNIT

---



CITY OF CAPE TOWN  
ISIXEKO SASEKAPA  
STAD KAAPSTAD

# PROJECT DELIVERY ROAD MAP

---

- **REPAIR TO CIVIL INFRASTRUCTURE**
- ✓ COMPLETION : 30/04/18
- ✓ **EHP TOP STRUCTURES**
- ✓ COMPLETION: DEC 2018



CITY OF CAPE TOWN  
ISIXEKO SASEKAPA  
STAD KAAPSTAD

**Thank You**

Making progress possible. Together.